

# Charging via QR code

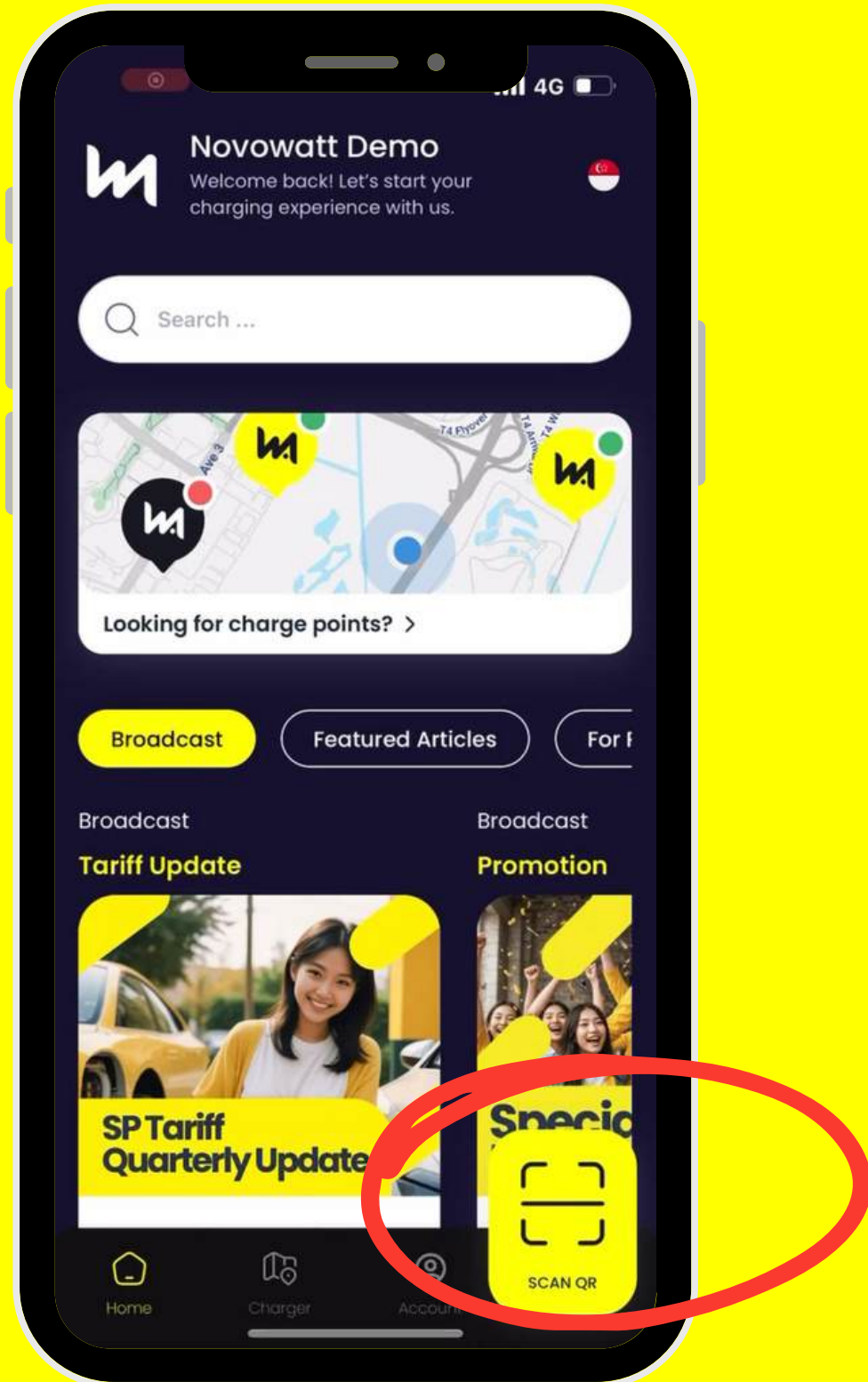

Plug in the connector and lock the car



Open WATT app and tap on the bottom right “Scan QR” icon

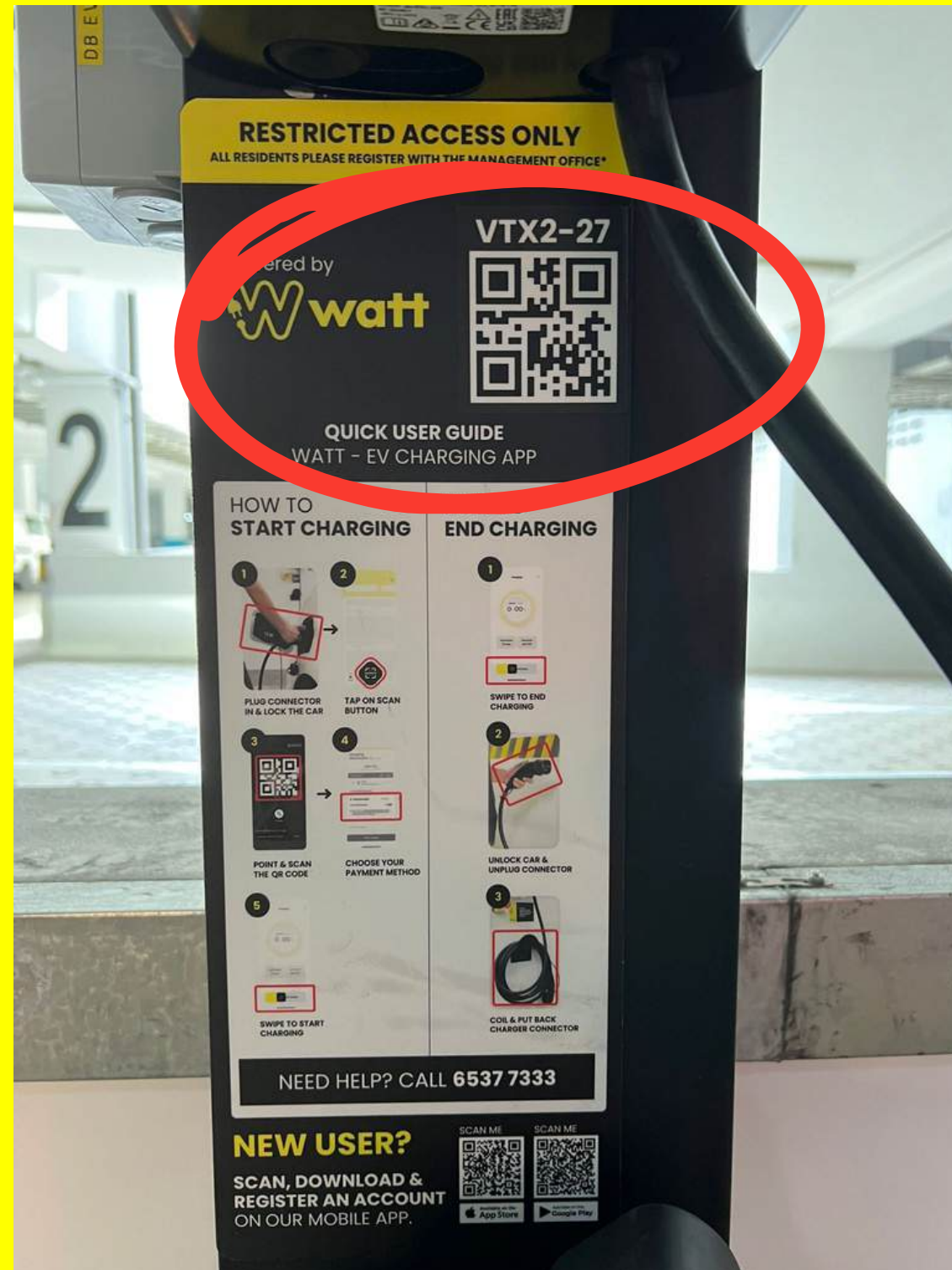
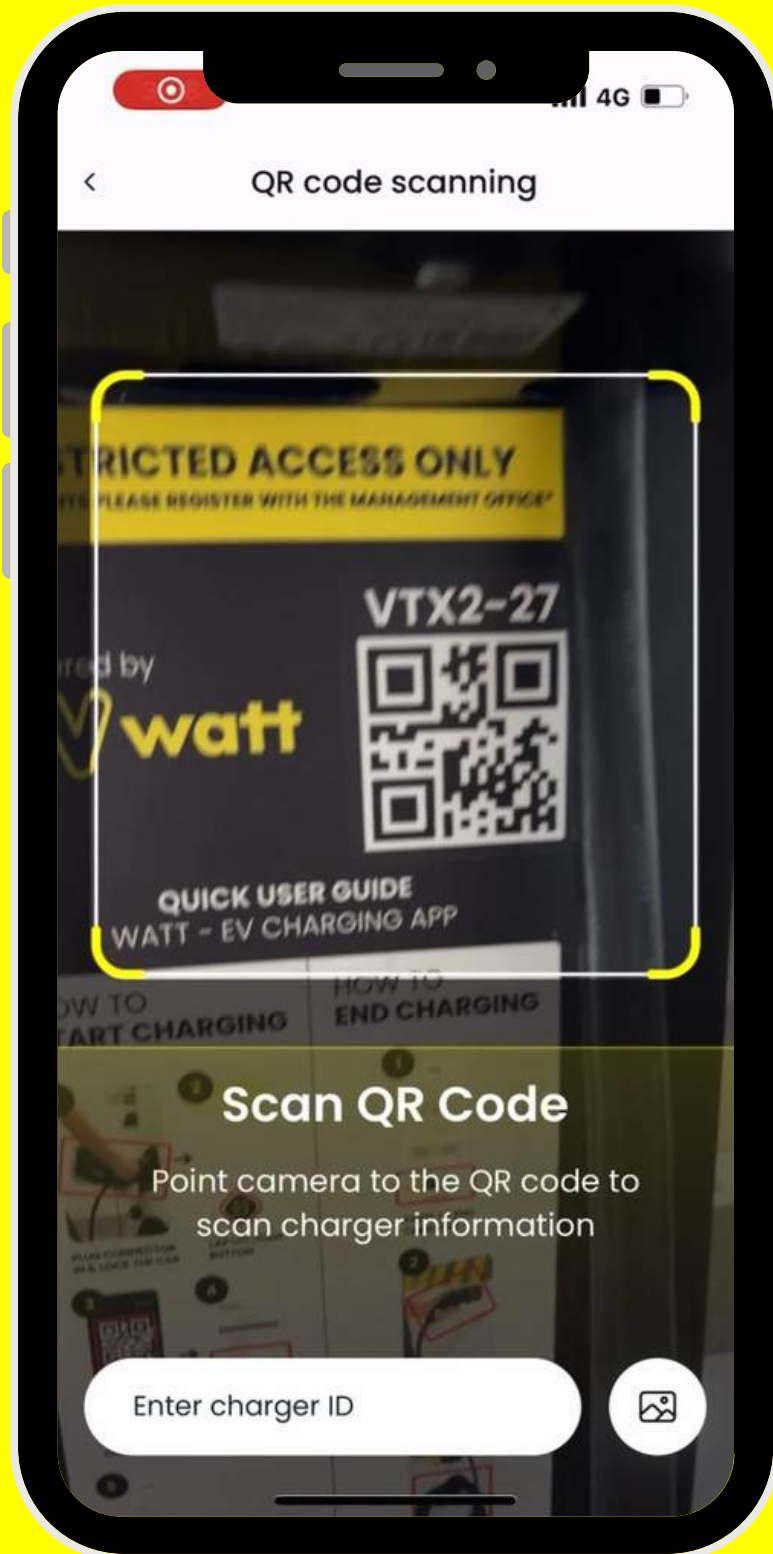

Direct the scanner to the QR code reflected on the top right of the charging station

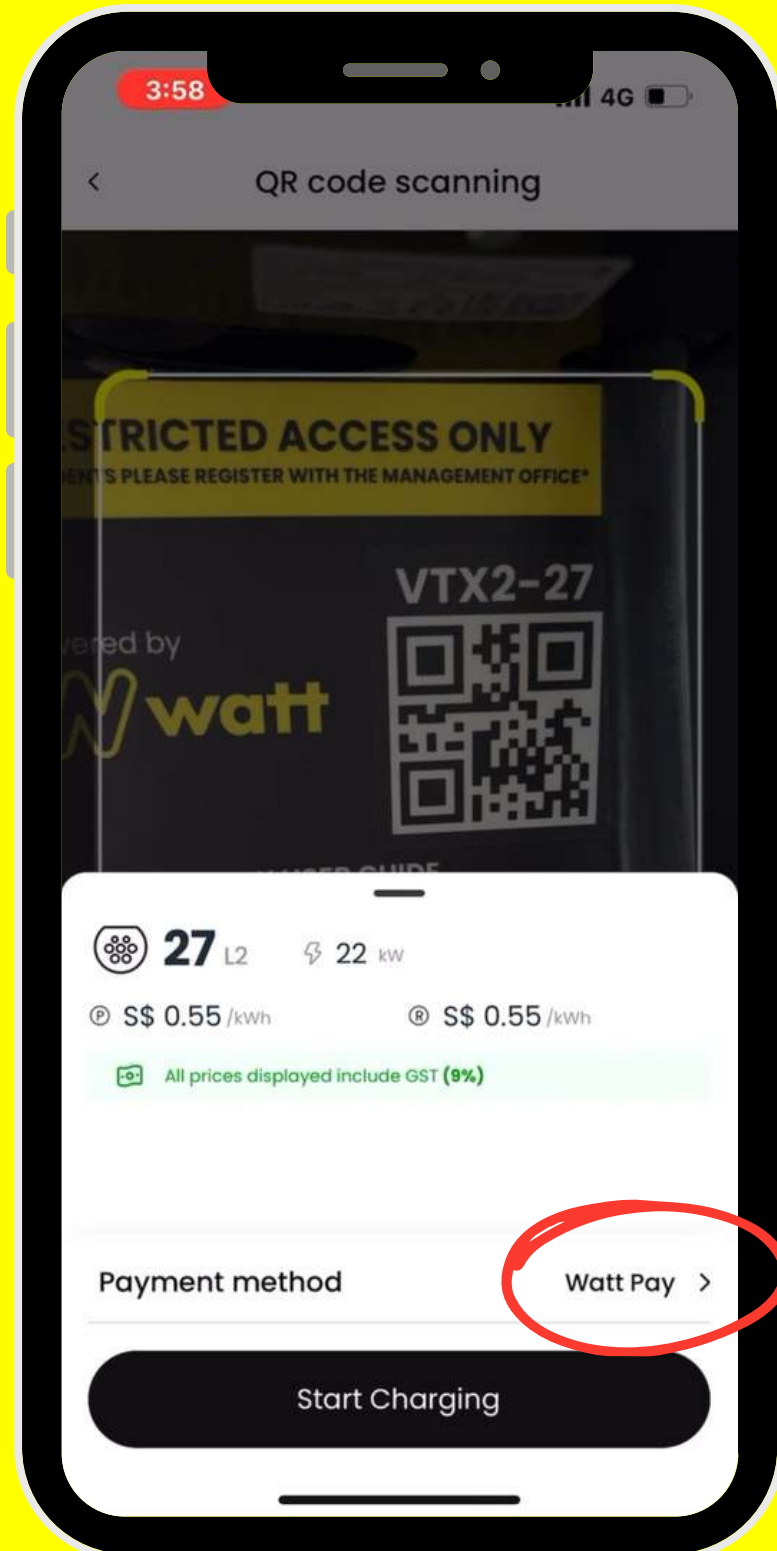

Check and confirm your payment method  
To change payment method, simply tap on the arrow to change

Once confirmed, tap on start charging

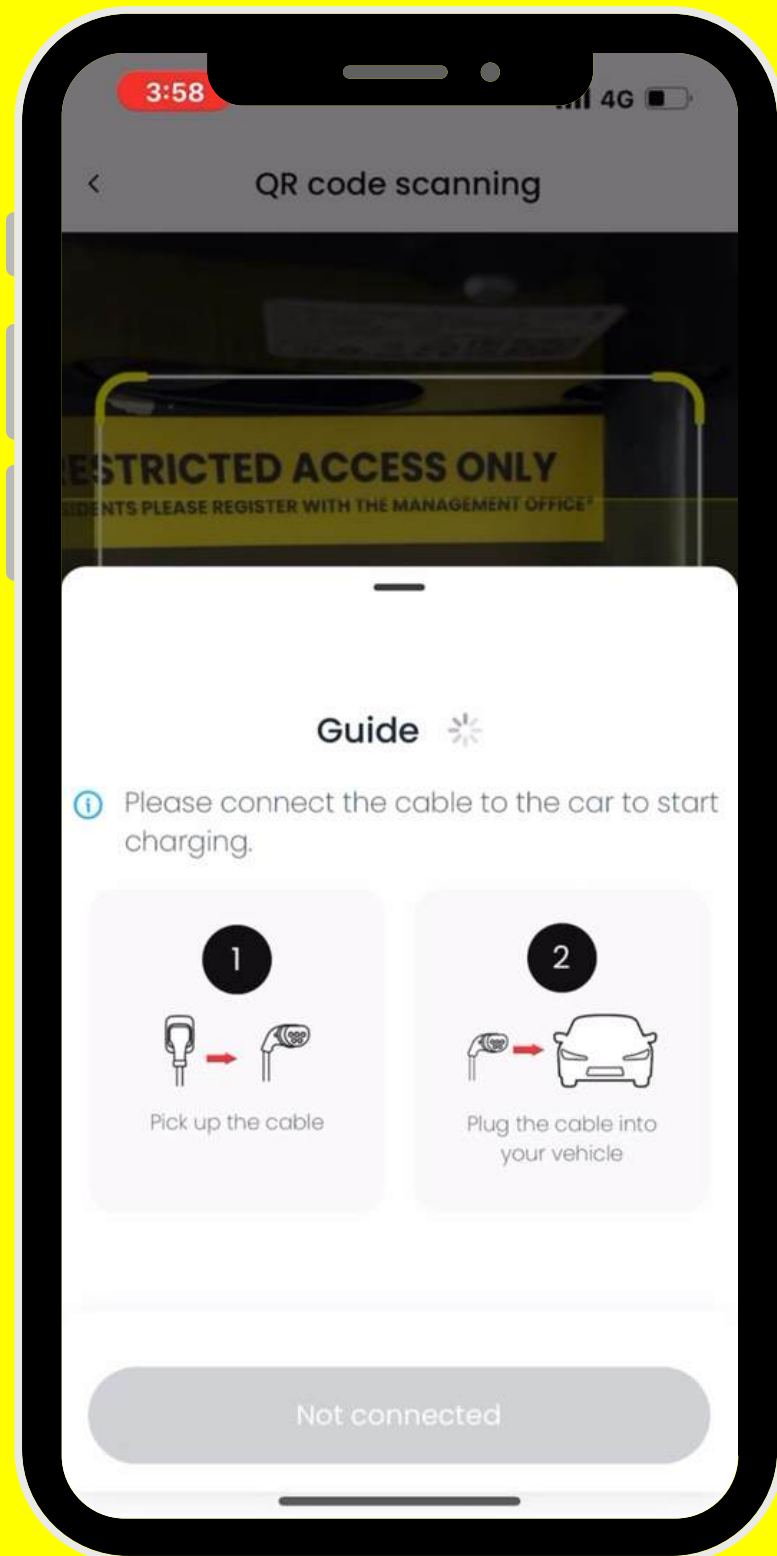

If this pop up appears, simply let it load for a few seconds.  
If it still doesn't work , unplug the connector and replug it in

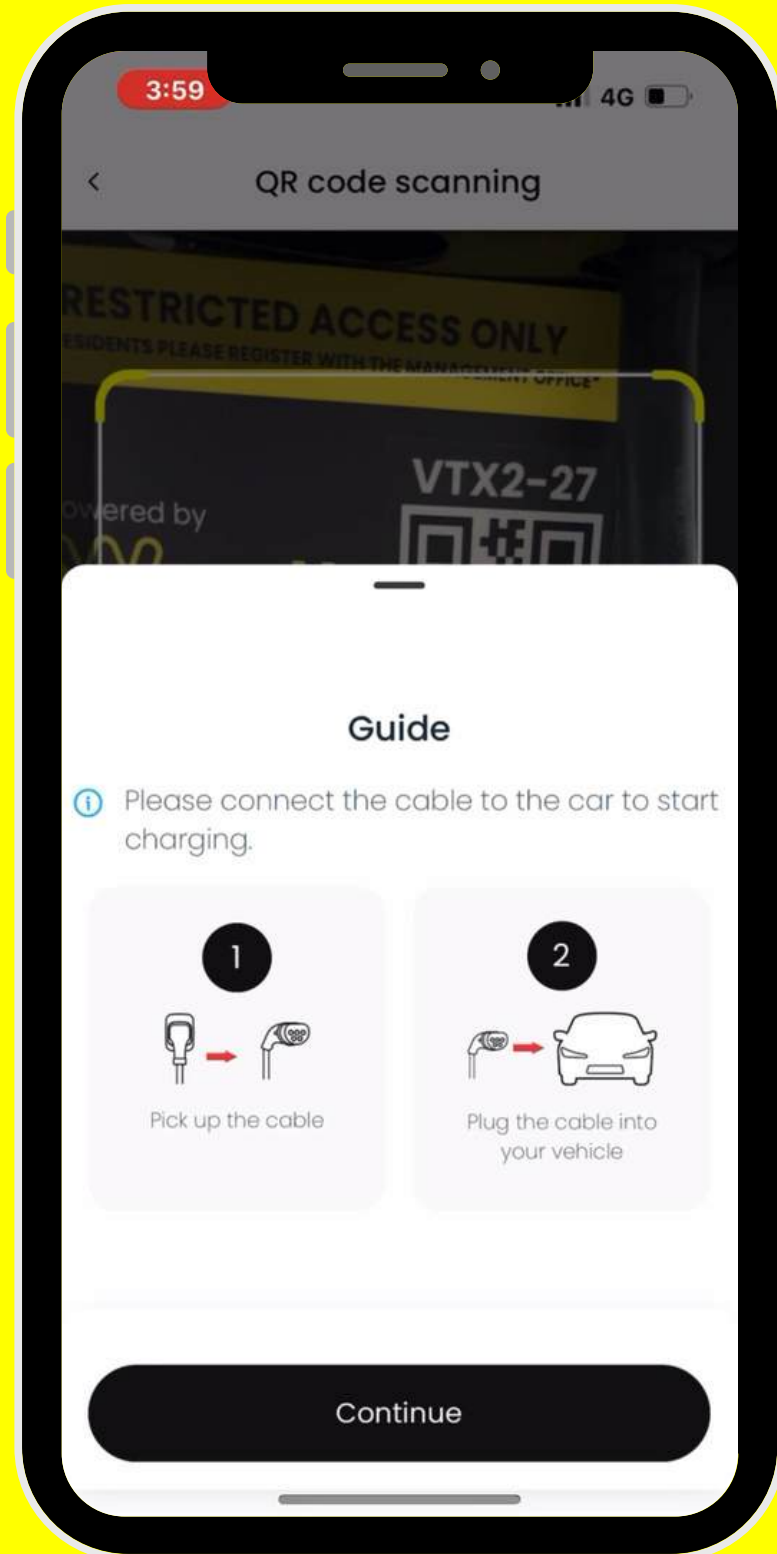

Tap “continue” after this pop up appears

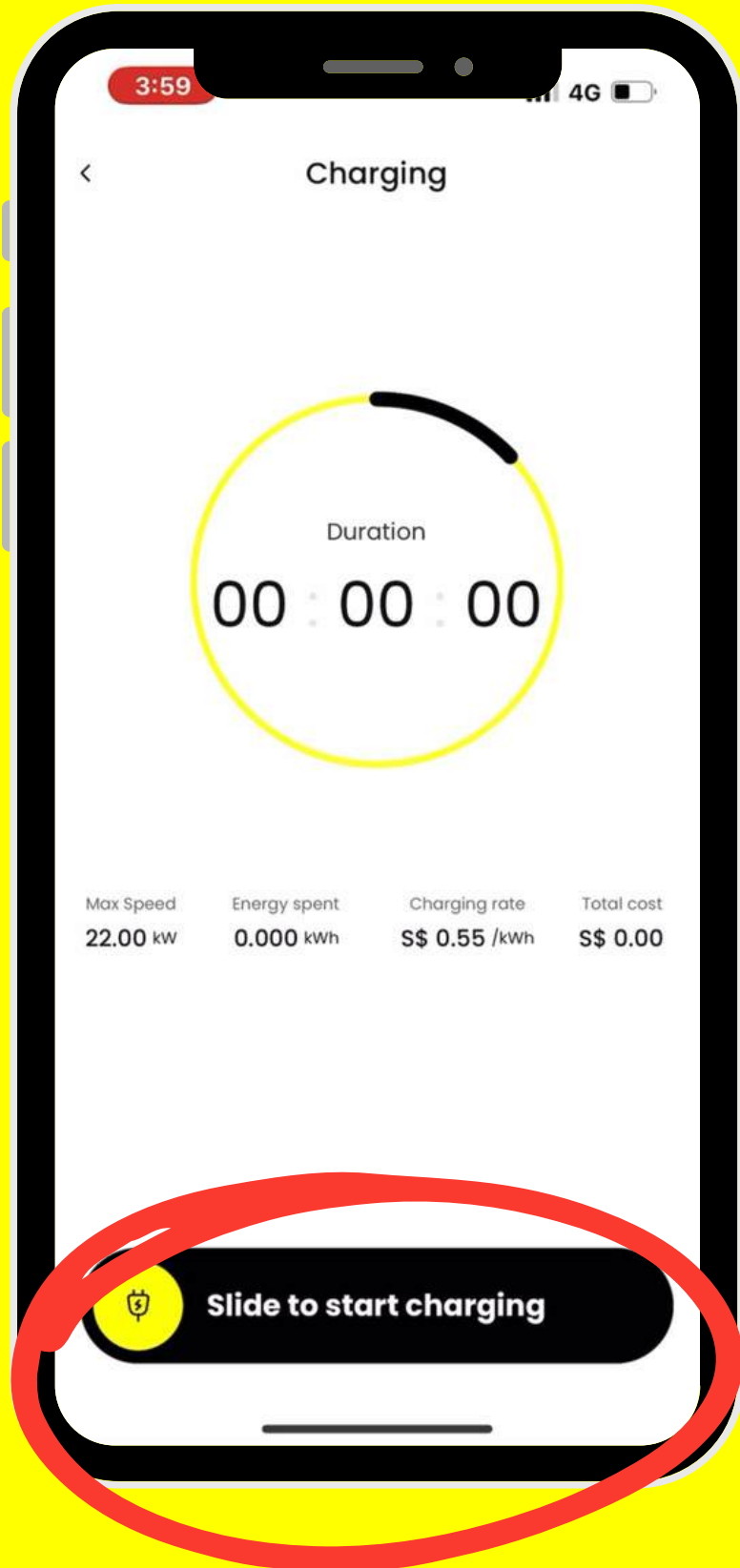

Slide to start charging

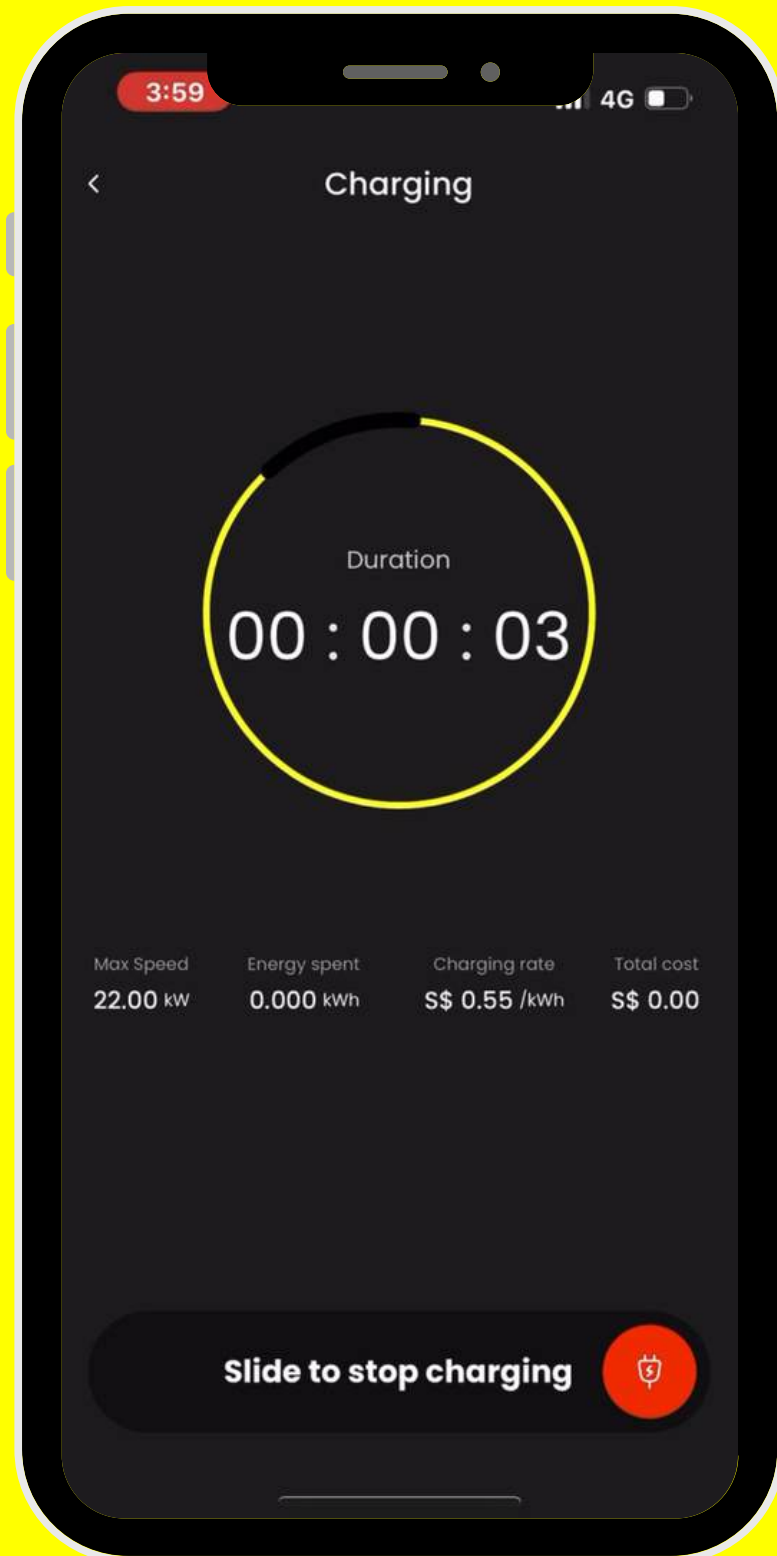

To stop charging, go to the app and slide to stop charging

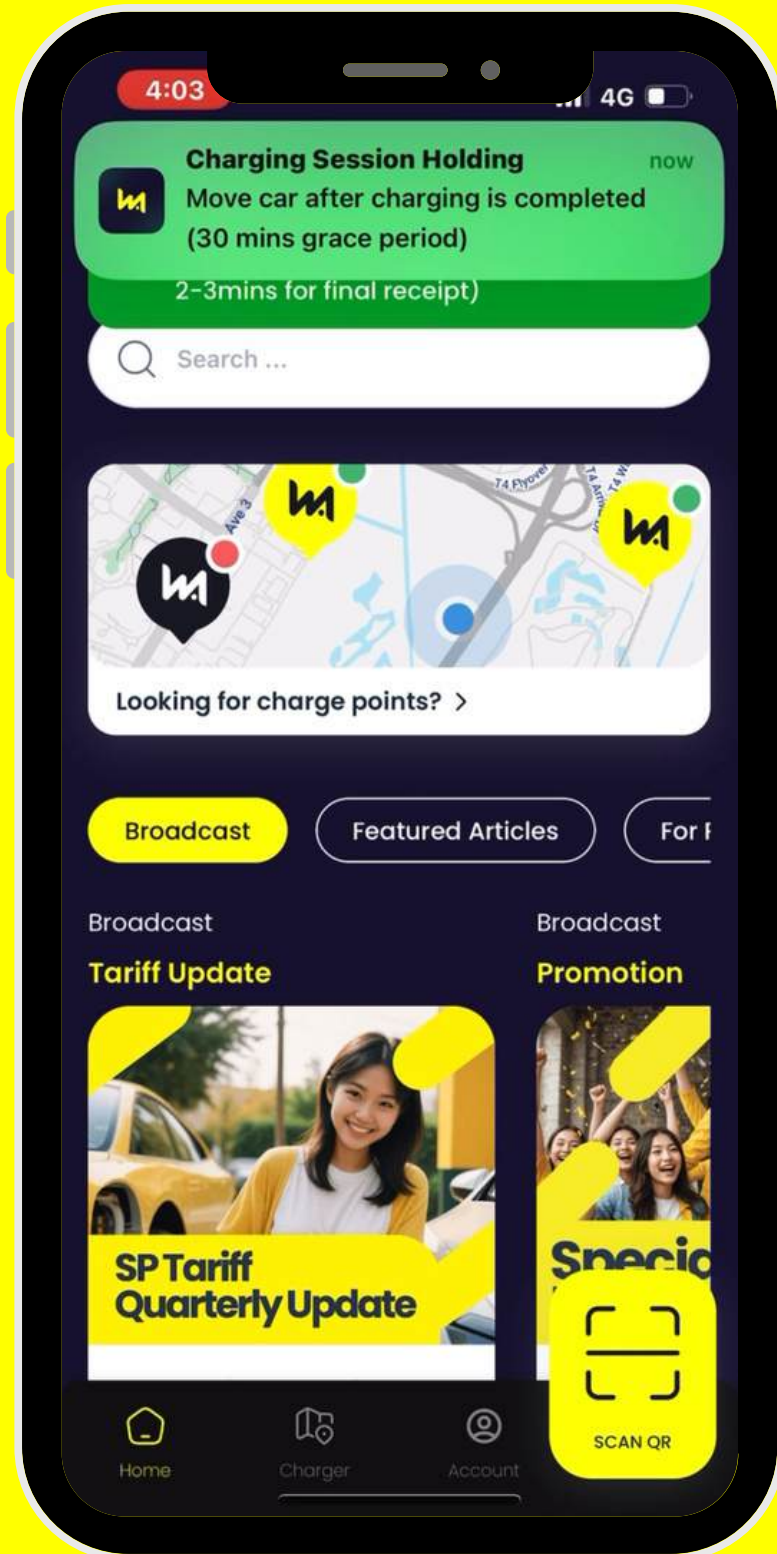

Once the charging is stopped , you will receive a notification to move your car away from the lot within the given idling period



Unlock car and unplug the connector  
before coiling and putting it back